

# SL

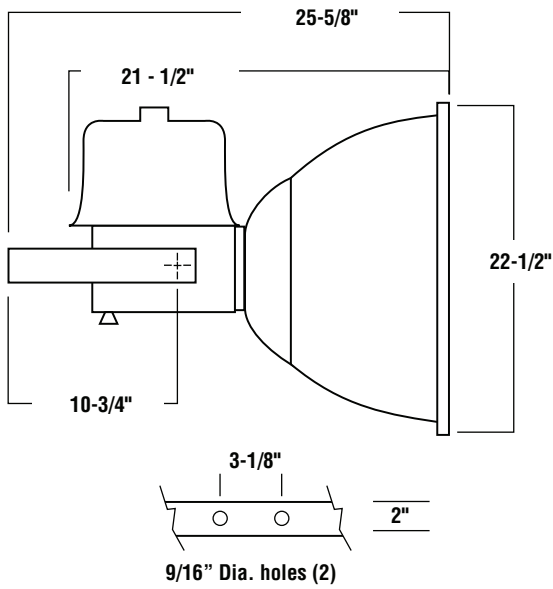

## DIMENSIONS



## YOKE MOUNTING DETAIL

SL - E.P.A. - 2.35

**HOUSING** - Ballast and socket housings are heavy duty die-cast aluminum.

**LENS/GASKET** - Flat clear tempered glass lens is sealed to the aluminum reflector with a silicone gasket.

**LENS RING** - The stainless steel lens ring is hinged and secured to the housing with three over-center spring tension clamps for positive locking. All hardware is stainless steel.

**SOCKETS** - Porcelain mogul-base sockets feature nickel-plated lamp grip screw shell.

**LIGHT SOURCES** - Pulse-Start Metal Halide, Metal Halide or High Pressure Sodium. Clear lamp is supplied as standard.

**BALLASTS** - High-power factor type CWA ballasts are rated for -20°

## REFLECTORS/DISTRIBUTION PATTERNS

- All SL fixtures are provided with a sealed reflector assembly which includes a 21" diameter one-piece spun aluminum electro brite reflector. SL fixtures have a vertical degree-aiming quadrant with positive position-stop and lock bolt and a removeable beam sight. Available in Type II (2), III (3), IV(4), V (5), and VI (6) beam spreads. Aiming range is 90° up and 90° down. Photometric data is tested in accordance with IESNA guidelines.

**MOUNTING** - For ease of installation, the SL is shipped as a complete unit in one carton. Includes a weatherproof, strain relief bushing and a sturdy, two-hole mounting yoke formed of high strength, non-corrosive, copper free, aluminum. Three foot 14/3 SO cord is offered as an option.

**FINISH** - Bronze polyester powder coat.

**PHOTOMETRICS** - Please visit our web site at [www.lsi-industries.com](http://www.lsi-industries.com) for detailed photometric data.



LISTED  
wet location



CSA Certified

## SHIPPING WEIGHTS - SL

Catalog Number	Est. Weight (kg/lbs.)	Length (mm/in.)	Width (mm/in.)	Height (mm/in.)
SL / SLU	30/67	610/24	610/24	610/24

# SL

## LUMINAIRE ORDERING INFORMATION



TYPICAL ORDER EXAMPLE: **SL 3 1000 MH F MT BRZ V**

Luminaire Prefix	Distribution	Lamp Wattage	Light Source	Lens	Line Voltage	Luminaire Finish	Options
SL SLU <sup>1</sup>	2 - 20 x 20	400	PSMU - Pulse-Start Metal Halide Universal 400 Watt	F - Flat Clear Tempered Glass	480 MT - Multi Tap TT - Tri-Tap	BRZ - Bronze	PCRPC - Photoelectric Control with twist lock Receptacle <sup>2</sup> FS120 - Single Fusing FS277 - Single Fusing FD208 - Double Fusing FD240 - Double Fusing FD480 - Double Fusing PLS - Polycarbonate Shield OH - Outer Housing V-Visor C- Cord (3' 14/3 SO) LL - Less Lamp
	2 - 26.4 x 26.8	1000	MH - Metal Halide 1000 Watt				
	3 - 41.3 x 39	1000	MH - Metal Halide 1000 Watt				
	4 - 65 x 63.5	400	HPS - High Pressure Sodium 400 Watt				
	4 - 63.5 x 63.5	1000 1500	MH - Metal Halide 1000, 1500 Watt				
	5 - 116 x 118	400	HPS - High Pressure Sodium 400, 1000 Watt				
	5 - 128 x 128	1000	MH - Metal Halide 1000, 1500 Watt				
	5 - 101.4 x 97.9	1000 1500	MH - Metal Halide 1000, 1500 Watt				
	6 - 113.3 x 102.7	400	HPS - High Pressure Sodium 400 Watt				
	6 - 136 x 137	1000	MH - Metal Halide 1000 Watt				

**MT - Multi Tap** consists of 120V, 208V, 240V and 277V and is prepared for highest voltage. Alternate voltages will require field adjustment.  
**TT - Tri-Tap** consists of 120V, 277V and 347V and is shipped standard for Canadian applications and is prepared for highest voltage. Alternate voltages will require field adjustment.

Consult factory for other light sources available for export.

### FOOTNOTES:

- 1- To order SL fixtures for uplighting applications, add "U" to order prefix.      2- Specify single line voltage.

ACCESSORY ORDERING INFORMATION (Accessories are field installed)		
Description	Order Number	Bracket
BKA-SL-2-* -NO-Crossarm Bracket <sup>+</sup>	380442	Horizontal Yoke Mounting, 180° Adjustment
BKA-SL-245-* -NO-Crossarm Bracket <sup>+</sup>	380443	Horizontal Yoke Mounting, 180° Adjustment
BKA-SL-290-* -NO-Crossarm Bracket <sup>+</sup>	112418	Horizontal Yoke Mounting, 180° Adjustment
BKA-SL-5-B-Slipfitter - No paint	159325	Pole Top Mounting (Slipfits 2" and 2-1/2" Pipe Tenon)
BKA-SL-5-B-BRZ Slipfitter - BRZ	159324	Pole Top Mounting (Slipfits 2" and 2-1/2" Pipe Tenon) BRZ
BKS-FBO-18-* -BRZ	107053BRZ	Floodlight Bracket (SL-5-B also required) BRZ
SL Visor/Lens Assembly	159331	

<sup>+</sup> Includes (2) 1/2" bolts. Not painted.



Polycarbonate Shield

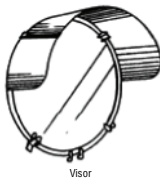

Visor

### MOUNTING BRACKETS

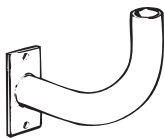

#### FBO-18-BRZ

For installations requiring horizontal fixture adjustment. Vertically mounted 2"(51mm) x 17-1/2"(445mm) pipe size tenon welded to a steel plate and secured by two bolts (SL-5-B also required). SF or DF pole preparation required.

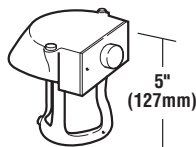

#### BKA-SL-5-B-Slipfitter

Pole Top Mounting Slipfits 2" (51mm) and 2-1/2" (64mm) Pipe Tenon (2-3/8" to 2-7/8" O.D.)

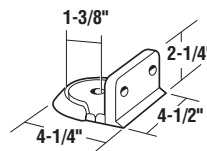

#### BKA-SL-2-\* -NO Cross Arm Bracket

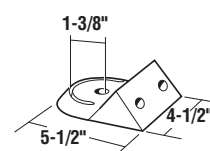

#### BKA-SL-245-\* -NO Cross Arm Bracket

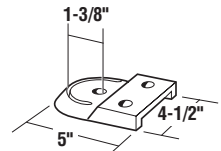

#### BKA-SL-290-\* -NO Cross Arm Bracket